

WELCOME

Those who are already familiar with typical Swiss values will hardly be surprised that Swiss Aviation Training chooses to offer its first-class training programmes right here, in the heart of Europe.

Punctuality and dependability, those legendary Swiss qualities, are as much part of the Training Center mentality as an uncompromising commitment to safety and a personalised, highly professional approach to service. With that in mind, we are keen not only to provide the highest level of training, but also to acquaint you a little better with Switzerland, your host country.

In fact, we positively encourage you to enjoy the odd excursion or two while you are over here. Whether you are drawn to the stunning mountain scenery, the vibrant buzz of the Zurich metropolis, or the history and culture of other Swiss cities – the choice is yours! All we would like to do is recommend a few highlights in particular.

Throughout your stay, you can be sure of our undivided attention and personalised, friendly support – before, during and after your training programme. So that when you return home, you take with you a piece of another Helvetic tradition: a large serving of Swiss hospitality. I very much hope you will feel happy and at home with us during what is sure to be a very successful training programme.

A friendly „Grüezi“



Capt. Manfred Brennwald

President & CEO
Chairman of the Board



ABOUT Swiss AviationTraining

Swiss AviationTraining and its prestigious training facilities – our Training Center has long enjoyed a reputation as one of the most innovative and dynamic – is located close to Zurich Airport.

For years, customers from all over the world have placed their confidence in us, and we are pleased to provide them with training of unrivalled quality. Our cutting-edge aviation expertise, total dependability, first-class service and integrity mark us out in virtually every area of the aviation industry. Besides training successful pilots, we can also offer tailor-made tuition for your cabin crew members and technicians. We have a wide choice of 'human factor' courses, too.

We would be delighted to provide you with further information about our training options.

More at:
swiss-aviation-training.com

ZURICH AIRPORT

You will land very close to us, at Zurich Airport. Besides flights to destinations around the world, Zurich Airport also offers a fabulous range of smart shops, a wide choice of restaurants and cafés and is an ideal starting point for excursions near and far.

There are several easy ways to get to the Training Center from Zurich Airport: you could take one of the regular buses departing from the bus station at the Airport and get out at „Werft“. Alternatively, you will find taxis and hotel shuttle buses in the areas in front of Arrivals 1 and 2.

More at:
zurich-airport.com – zvv.ch



OUR TRAINING EQUIPMENT

Full Flight Simulators

A321-100 (2 simulators)

A330-200 / A340-300

A330-300 / A340-300

McDonnell Douglas MD-83

Embraer ERJ145

Embraer E170

Embraer E190/5 (located in Munich)

Fixed-base Flight Training Devices

FNPT II Piper Seneca V, PA34 (2 simulators)

FNPT II Beech King Air 200 (MCC)

FNPT II Diamond DA-42 Twin Star

Training Aircrafts

Piper Cadet-Archer-Arrow-Seminole

Diamond DA-42 Twinstar

Integrated Procedure Trainers CAE Simfinity

Embraer E170

Airbus A320 / A330 / A340

Cabin Emergency Evacuation Trainer (CEET)

Airbus A319 / A320 / A321 (motion)

Airbus A330 / A340 (fixed base)

Embraer E170 (fixed base)

Door Trainer

Airbus A319 / A320

Airbus A330 / A340

Avro RJ-85/100 (with sliding device)

Boeing B-737 (with sliding device) / B-757 / B-767

McDonnell Douglas MD-11

Other training facilities

Inflight service mock-up

Medical mock-up

Cosmetics & coiffeur room

Computer-based training stations with courseware for pilots, cabin crews and maintenance

Class, group and briefing rooms

Web-based Training

FLOOR PLAN

HOW TO FIND YOUR WAY AROUND

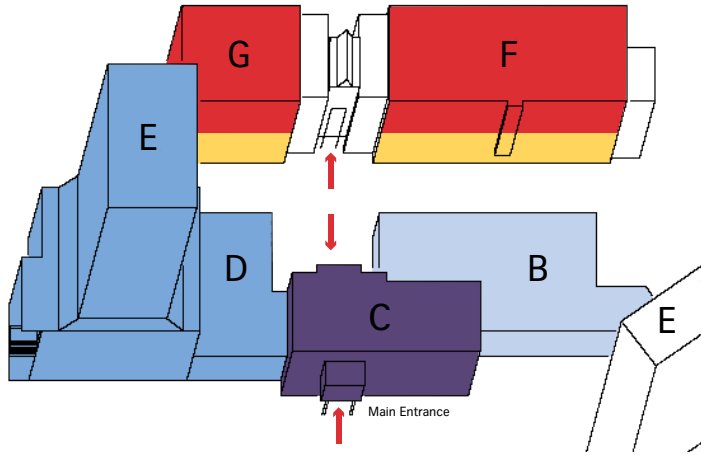

- Office
- Briefing Rooms
- Elevators
- Restrooms
- Sales Office
- Cabin Crew Training Devices
- Simulators
- Simulators/Mock-ups
- Reception
- Cafeteria

GROUND FLOOR

Building E & D

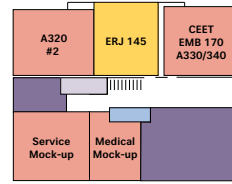

FIRST FLOOR

Building E

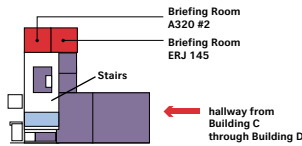

FIRST FLOOR

Building G

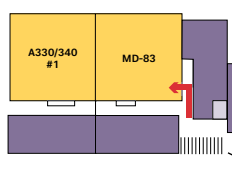

THIRD FLOOR

Building G

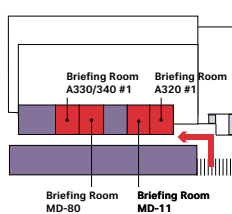

GROUND FLOOR

Building E & D

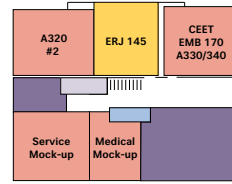

FIRST FLOOR

Building E

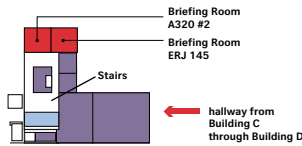

FIRST FLOOR

Building G

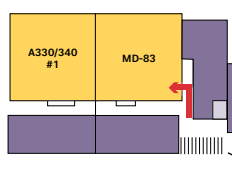

THIRD FLOOR

Building G

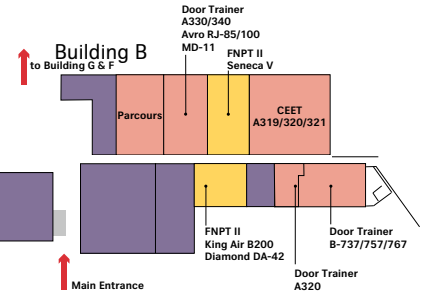
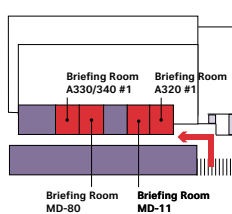

FIRST FLOOR

Building G

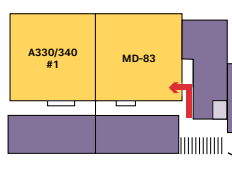

THIRD FLOOR

Building G

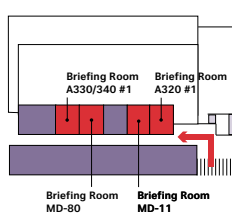

Building F

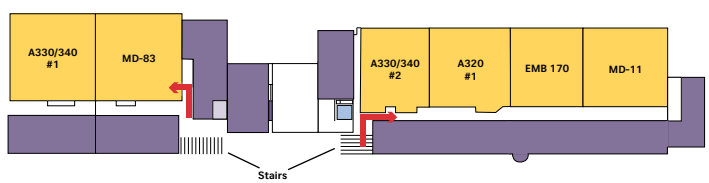

THIRD FLOOR

Building G

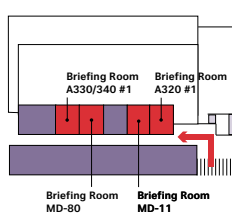

Building F

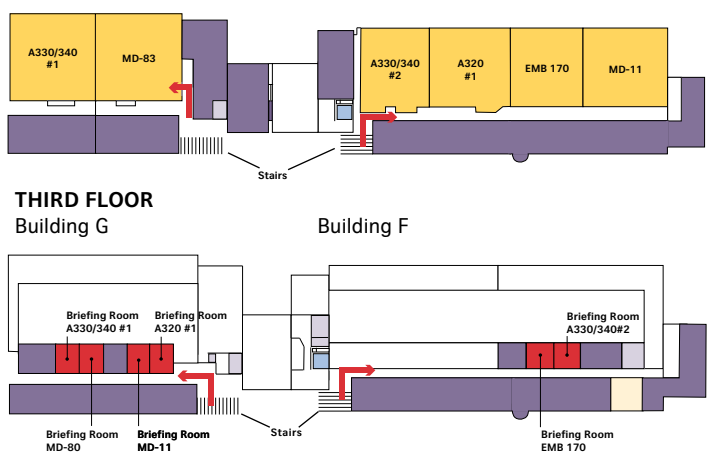



10 AT Swiss Aviation Training

—

If you have any questions or queries, the Reception Desk in Building C is your first port of call. You can pick up your personal access badge here, too. The Reception Desk is manned from Monday-Friday, 8 am to 5 pm. When the Desk is closed, use the exterior telephone (main entrance, Building C) to contact Maintenance for round-the-clock access.

If you have a WLAN-enabled laptop, you can access the Internet via our hotspot. Alternatively, you can use our Internet-Corner on the 2nd floor of Building F, or the Internet-Café in Building E, 4th floor (room E 462).

11

Fancy a cup of coffee, a snack, a sandwich or a hot lunch? Head over to Building B, where you will find a cosy cafeteria open Monday to Saturday from 7.30 am to 2 pm. Drinks and snack machines are also available in every building.

The nearby Staff Restaurant Balsberg (open Monday to Friday from 11.30 am to 1.30 pm) also offers a varied choice of international dishes. And don't forget the many restaurants and cafés at the Airport itself.

More at:
compass-group.ch/balsberg – zurich-airport.com



12

13

PUBLIC TRANSPORT

—



Trains to Zurich and Winterthur depart from „Balsberg“ train station (right next to the Training Center) every 30 minutes. In both cases, the journey time is approx. 20 minutes.

The „Werft“ bus stop is located just outside Building C. There is a regular bus service between this stop and the Airport. Buy your ticket in the bus or before you travel.

You can purchase all manner of train and bus tickets at the SBB counter in Zurich Airport. There is also a direct train service into Zurich.

TIP:

A „ZürichCARD“ entitles you to free travel on all public transport, plus attractive discounts and free admission to a range of fascinating museums. You can buy your „ZürichCARD“ at train stations, the Tourist Service and certain hotels. If you are planning a lengthy stay, it might be worth buying a season ticket („Abo“) or a multi-trip ticket („Mehrfahrtenkarte“).

The map on page 4 shows the above-mentioned bus and train stations.

More at:

flughafen-zuerich.ch – zvv.ch – sbb.ch – zuerichcard.com

HOTELS NEAR THE AIRPORT

Hilton *****

Hohenbühlstrasse 10 – 8152 Glattbrugg
Tel. +41 44 828 50 50 – Fax +41 44 828 51 51
zurich@hilton.com – hilton.com
Linear distance to Training Center: 590 m



NH Hotels ****

Schaffhauserstrasse 101 – 8152 Glattbrugg
Tel. +41 44 808 50 00 – Fax +41 44 808 51 00
nhzurichairport@nh-hotels.com – nh-hotels.com
Linear distance to Training Center: 1.09 km



Park Inn ****

Flughofstrasse 75 – 8153 Rümlang
Tel. +41 44 828 86 86 – Fax +41 44 828 86 87
info.zurich@rezidorparkinn.com – rezidorparkinn.com
Linear distance to Training Center: 2.44 km



Fly Away ***

Marktgasse 19 – 8302 Kloten
Tel. +41 44 804 44 55 – Fax +41 44 804 44 55
reservation@hotel-flyaway.ch – hotel-flyaway.ch
Linear distance to Training Center: 1.36 km



Welcome Inn ***

Hohlbergstrasse 1 – 8302 Kloten
Tel. +41 44 804 75 75 – Fax +41 44 804 75 74
reservation@hotel-welcomeinn.ch – hotel-welcomeinn.ch
Linear distance to Training Center: 1.16 km



Hotel Mövenpick Zurich Airport *****

moevenpick-hotels.com Linear distance to Training Center: 328 m

Hotel Belair ****

belair-hotel.ch Linear distance to Training Center: 3.28 km

Hotel Best-Western Airport *****

hotel-airport.ch Linear distance to Training Center: 1.37 km

Hotel Novotel Zurich Airport Messe *****

novotel.com Linear distance to Training Center: 1.97 km

Radisson SAS HOTEL *****

zurich.radissonsas.com Linear distance to Training Center: 1.95 km

Apart Hotel ***

aparthotelzurich.ch Linear distance to Training Center: 480 m

Other hotels:

Hotel Renaissance, Swissôtel Zurich, Hotel Coronado, Ibis Zurich Airport, Hotel Courtyard by Marriott, Hotel Allegra

See pages 30 and 31 for a map of all the above-mentioned hotels near the Airport and in Zurich.

More at:

airport-hotels.ch – zurich.airporthotelguide.com – hotels.com – hrs.com



HOTELS IN ZÜRICH

—

Marriott Zürich *****

Neumühlequai 42 – 8001 Zürich
Tel. +41 44 360 70 70 – Fax +41 44 360 77 77
marriott.zurich@marriotthotels.com – marriott.com
Linear distance to Training Center: 6.99 km



Central Plaza ****

Central 1 – 8001 Zürich
Tel. +41 44 256 56 56 – Fax +41 44 256 56 57
info@central.ch – central.ch
Linear distance to Training Center: 8.40 km

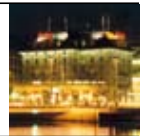

Crowne Plaza ****

Badenerstrasse 420 – 8040 Zürich
Tel. +41 44 404 44 44 – Fax +41 44 404 44 40
info@cpzurich.ch – crowneplaza.com
Linear distance to Training Center: 8.23 km



Schweizerhof ****

Bahnhofplatz 7 – 8023 Zürich
Tel. +41 44 218 88 88 – Fax +41 44 218 81 81
info@hotelschweizerhof.com – hotelschweizerhof.com
Linear distance to Training Center: 8.45 km



Ibis Zürich-City **

Schiffbaustrasse 11 – 8005 Zürich
Tel. +41 44 276 21 00 – Fax +41 44 276 21 01
h2942@accor.com – ibishotel.com
Linear distance to Training Center: 6.88 km

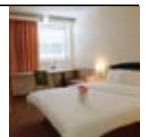



20 ABOUT SWITZERLAND

Official name	Swiss Confederation
----------------------	---------------------

Area	41,293 km ²
-------------	------------------------

Population	7.4 million
-------------------	-------------

Capital	Berne
----------------	-------

National languages	German, French, Italian, Romansh
---------------------------	----------------------------------

Money	Swiss franc: 1 Swiss franc = 100 Rappen
--------------	---

Many stores in the larger towns will also accept **Euros**. You will get the best **exchange rate** for cash or foreign currency traveller's cheques at any of the Swiss banks. Only bank notes are accepted for exchange. All major **credit cards** are accepted. Debit cards are very popular, and there are plenty of ATMs for cash withdrawals.

Visa

You need a valid **passport** to enter Switzerland. EU nationals and nationals from certain other countries are entitled to stay for three months without a visa. Please see www.swissemb.org for detailed information.

Time zone	GMT+1 (CET) – early November – end of March GMT+2 (CEST) – end of March – end of October
------------------	---

Mains power supply	230 volts/AC
---------------------------	--------------

Climate in Zurich

Zurich	Jan	Feb	Mar	Apr	May	Jun	Jul	Aug	Sep	Oct	Nov	Dec
Av. temperature (day)	2	5	10	15	19	23	25	24	20	14	7	3
Av. temperature (night)	-3	-2	1	4	8	12	14	13	11	6	2	-2
Hours' sunshine/day	2	0	5	6	7	7	8	7	6	4	2	1
Days' rain/month	12	10	9	11	13	13	13	13	10	10	10	10



22

Units of measure

Metric system

Telephone

The international prefix for Switzerland is: +41

When phoning Switzerland from abroad, dial the international prefix and omit the first zero in the number you are calling.

Example: number you want to dial 044 564 59 00 → dial +41 44 564 59 00

When calling abroad from Switzerland, start by dialling the appropriate international prefix.

Worth visiting

Berne, Geneva, Lucerne, Basel, St. Gallen, Lausanne

More at:

myswitzerland.com – switzerland.com – swissworld.org

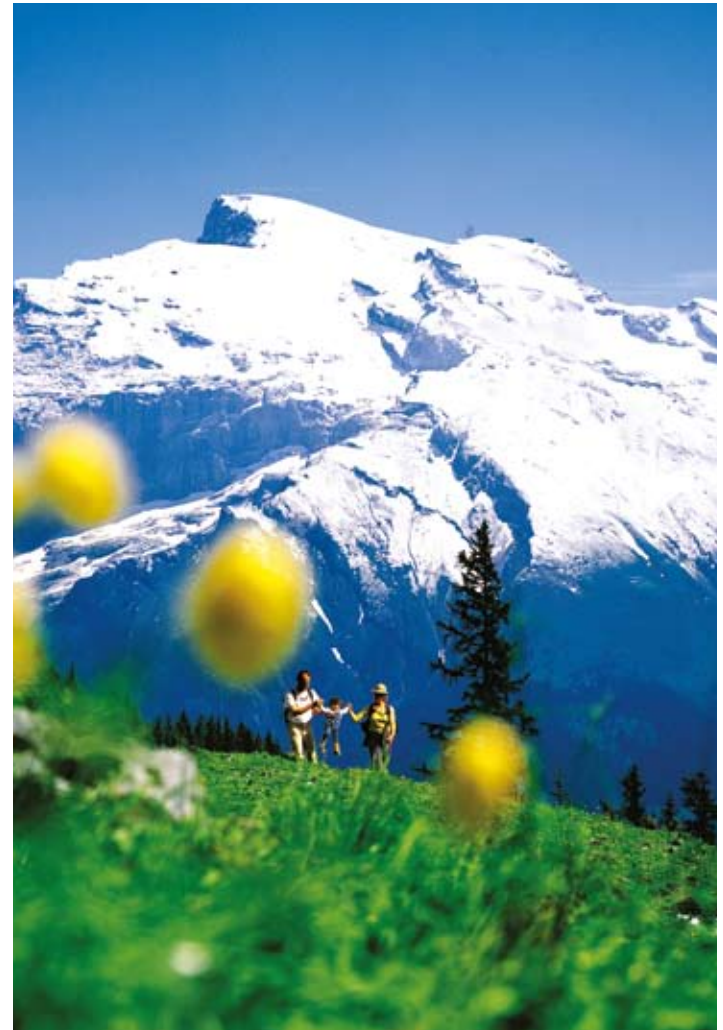

23



© Zürich Tourismus

ZÜRICH

With a population of some 370,000, Zurich is Switzerland's largest city – the national capital is Berne, but the country's economic, cultural and social heart is in Zurich. If time is too short to walk, buy yourself a tram ticket at any station, hop on board and zig-zag your way across this buzzing city.

Drop by the **Tourist Service** at Zurich Main Station for lots of useful information, excursion ideas galore, hotel reservations and guided tours, plus tickets for events, performances and public transport. Open 365 days a year.

The river Limmat is fed by Lake Zurich: flowing through the city, it divides the well preserved old town in two. The right bank is home to the famous Great Cathedral, or **Grossmünster**, and on the left bank you will find the **Fraumünsterkirche** (Our Lady's Minster) with its beautiful Marc Chagall stained glass

choir windows. Don't miss the **Opera House** (the first in its time to be equipped with electric light) and the **Kunsthaus** (Museum of Fine Arts), housing works by Picasso, Munch and Monet.

A stroll around the **lake** is always memorable – whether in summer, when the water sparkles in the sunlight, or in winter, when all is dusted with snow. In the summer season, a boat trip is an excellent way of seeing the old town from another angle.

The **Polyterrasse** is perhaps the best place to enjoy stunning views across the roofs of Zurich. The „Polybahn“ funicular will take you up to this panoramic platform in minutes. Just next to the Polyterrasse you will find the **Swiss Federal Institute of Technology (ETH)**, one of Europe's leading universities.

Everyone has heard of the Bahnhofstrasse, of course! One of Europe's best known and most attractive shopping roads, the Bahnhofstrasse has it all – from luxury designer clothes to the cheap-and-cheerful prêt-à-porter of the international chain stores, not to mention those famous Swiss watches!

If you like the appeal of the original, and are keen on a bargain too, you should head over to the Niederdorf district (also known as the „Dörfli“).

By day, the shops are crammed with folks of all ages looking for a good buy, and at night the bars and restaurants provide a cosy backdrop for a cool beer or dinner out with friends.

If Swiss souvenirs are on your shopping list, look no further than Heimatwerk (Uraniastrasse 1, tram no. 4 and 15 to „Rudolf-Brun-Brücke“), or Teddys Souvenir Shop (Limmatquai 34, tram no. 4 and 15 to „Helmhaus“).

There is lots to see and do in the Zurich surroundings, as well. Drop by one of the museums in Winterthur, for example, take a stroll through the romantic old town or see one of the many cultural events on offer.

Picturesque Schaffhausen is well worth a visit, too, especially for the spectacular Rhine Falls, the largest waterfalls in Europe.

Rapperswil, the city of roses, also boasts a very pretty old town with medieval castle built right on the shores of glorious Lake Zurich.

More at:

zuerich.com – zuerich.info – winterthur-tourismus.ch
schaffhausen-tourismus.ch – zuerichsee.ch





RESTAURANTS NEAR THE AIRPORT

Runway 34

Rohrstrasse 67
8152 Glattbrugg
Tel. +41 43 816 34 34
Fax +41 43 816 34 16
runway34.ch



Gasthaus Hans im Glück

Graswinkelstrasse 54
8302 Kloten
Tel. +41 44 800 15 15
Fax +41 44 800 15 17
pigna.ch



Geerlisburg

Gerlisberg
8302 Kloten
Tel. +41 44 813 71 46
Fax +41 44 813 71 05
geerlisburg.ch



F50 Restaurant, Lounge and Bar

Flughofstrasse 50
8152 Glattbrugg
Tel. 41 44 874 29 70
Fax 41 44 810 37 04
F50.ch



Hotel Mövenpick Zurich Airport

Walter Mittelholzerstrasse 8
8152 Glattbrugg
Tel. +41 44 808 85 55 (Appenzeller Stube)
Tel. +41 44 808 85 44 (Dim Sum)
moevenpick-hotels.com



RESTAURANTS IN ZURICH

Zeughauskeller

Bahnhofstrasse 28a
8001 Zürich
Tel. +41 44 211 26 90
Fax +41 44 211 26 70
zeughauskeller.ch



Hiltl

Sihlstrasse 28
8001 Zürich
Tel. +41 44 227 70 00
Fax +41 44 227 70 07
hiltl.ch



Seerose

Seestrasse 493
8038 Zürich
Tel. +41 44 481 63 83
Fax +41 44 481 63 85
dinning.ch



Du Théâtre

Dufourstrasse 20
8008 Zürich
Tel. +41 44 251 48 44
Fax +41 44 251 48 45
du-theatre.ch



Vorderer Sternen

Theaterstrasse 22
8001 Zürich
Tel. +41 44 251 49 49
Fax +41 44 252 90 63
vorderer-sternen.ch



CLUBBING IN ZURICH

—

Kaufleuten

Pelikanstrasse 18
8001 Zürich
kaufleuten.ch



Indochine

Limmatstrasse 275
8005 Zürich
club-indochine.com



Acqua

Mythenquai 61
8002 Zürich
acqua-club.ch



Alpenrock House

Parkhaus 5
8058 Zurich-Airport
alpenrock-house.com



Mascotte

Theaterstrasse 10
8001 Zürich
mascotte.ch



More at:

zueritipp.ch (in German only) – tilllate.com – usgang.ch

BARS / CAFÉS IN ZURICH

—

Wings Lounge

Limmatquai 54
8001 Zürich
wings-lounge.ch



Almodobar

Bleicherweg 68
8002 Zürich
almodobar.ch



Terrasse Restaurant, Lounge and Bar

Limmatquai 3
8001 Zürich
bindella.ch



Sprüngli am Paradeplatz

Bahnhofstrasse 21
8022 Zürich
spruengli.ch



Schober

Napfgasse 4
8001 Zürich
cafe-conditorei-schober.ch



